

# 4310B Drum Chipper

The Peterson 4310B is designed for high volume biomass producers.

4310B With Optional Top Load Spout.

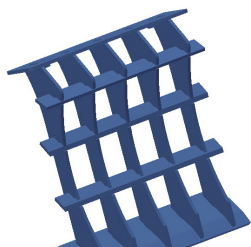

## Superior Product Sizing

Peterson's secondary grate system provides ultra-consistent chip sizing; twigs and small stems which can be difficult to size are easily fractured through our innovative system.



## Aggressive Feeding System

A sloped feed deck and three strands of WHD 120 feed chain, paired with an aggressive feed roll make loading the 4300-series easy in all types of material.

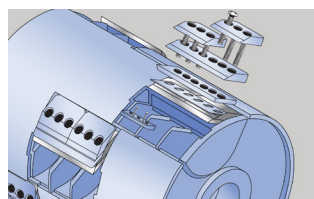

## Knife Assemblies: At The Heart of the Chipper

Produced from the highest quality alloy chromium steel, heavy-duty Peterson knife assemblies achieve uniform production of wood chips with high accepts and minimal losses.

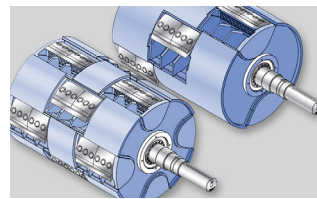

## Select From 6 or 12-Pocket Drum Styles

Featuring durable AR450 wear surfaces, the 4310B comes standard with a 6-pocket drum rotor with one Babbitted knife per pocket. A 12-pocket drum rotor is available for chipping microchips.

**The 4310B track mounted drum chipper is suited for high volume biomass producers who have a wide variety of feed material from brush and small feed stock to logs up to 24 inches (61 cm) in diameter.**

The 4310B is powered by a 765 horsepower (570 kW) C18 Caterpillar engine. At 58,500 pounds (26 535 kg), the track mounted 4310B is designed for operations requiring high production and frequent moves between jobs.

The chipper utilizes a 36 inch diameter by 44¾ inch (91 by 114 cm) wide drum with either 6 or 12 knife pockets. Traditional

babbitt type knife systems are standard equipment. Chip length can be set from 1/8 to 1¼ inch (3 to 32 mm) depending on rotor and knife configuration. Peterson's chip accelerator system, adds load density, or throws chips well away from the machine for land clearing operations.

Other key features include a hydraulic clutch, sloped feed deck for ease of feeding the chipper, and wear resistant AR 400 wear surfaces on the drum pockets and shell. Optional material sizing grates further reduce oversize twigs and branches in the chips, and an optional

chip accelerator helps with loading. The 4310B comes equipped with a wireless remote transmitter, putting control in the palm of your hand.

The end load spout is standard, and an optional top loading spout is available.

Since 1981, Peterson has specialized in the developing of delivery and processing equipment that turns low-grade organic materials into high value products.



**Peterson**  
an Astec Industries Co.

# 4310B Dimensions

## 4310B With Optional Top Load Spout

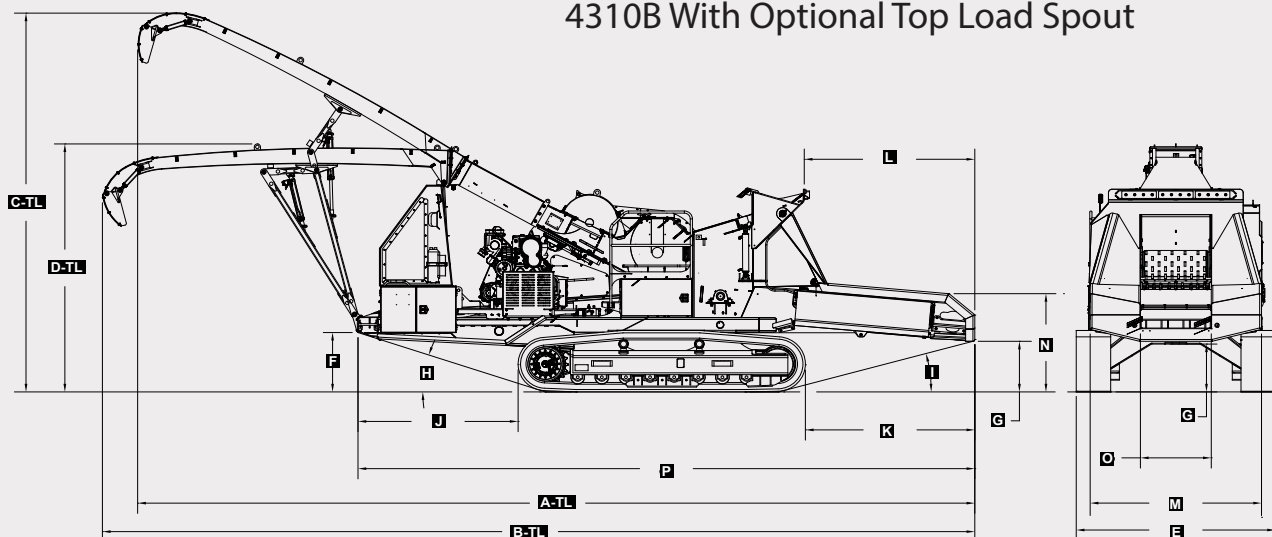

Scan with your smartphone  
to see a video of the 4310B



## 4310B With End Load Spout

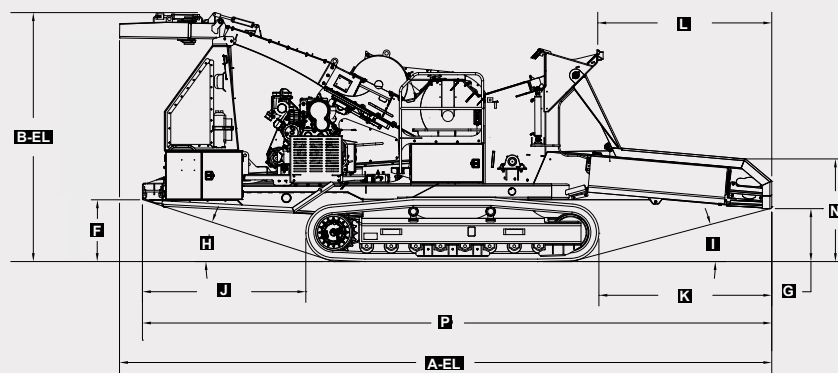

### Dimensions & Weights

#### Top Load Spout

|                               |                        |
|-------------------------------|------------------------|
| A-TL Operating Length         | 40' (1220 cm)          |
| B-TL Travel Length            | 41'-7" (1268 cm)       |
| C-TL Operating Height         | 18'-6" (564 cm)        |
| D-TL Travel Height            | 12'-1" (368 cm)        |
| Weight (depending on options) | 65,000 lbs (29 483 kg) |

#### End Load Spout

|                               |                        |
|-------------------------------|------------------------|
| A-EL Operating Length         | 30'-5" (928 cm)        |
| B-EL Travel/Operating Height  | 11'-7" (354 cm)        |
| Weight (depending on options) | 58,500 lbs (26 535 kg) |

# 4310B Specifications

### Dimensions

|                              |                  |
|------------------------------|------------------|
| E Width 500 mm track pads    | 10'-3" (312 cm)  |
| Width Opt. 600 mm track pads | 10'-6" (320 cm)  |
| F Front Ground Clearance     | 2'-10½" (88 cm)  |
| G Rear Ground Clearance      | 2'-4" (71 cm)    |
| H Front Clearance Angle      | 15 degree        |
| I Rear Clearance Angle       | 18 degree        |
| J Front Overhang             | 7'-¾" (233 cm)   |
| K Rear Overhang              | 9' (246 cm)      |
| L Feed Deck Length           | 8'-2" (249 cm)   |
| M Feed Deck Width            | 8'-2" (249 cm)   |
| N Feed Deck Height           | 4'-9½" (146 cm)  |
| O Feed Width                 | 3'-4½" (103 cm)  |
| P Frame Length               | 29'-4½" (895 cm) |

### Ground Pressure—Top Load Spout

|                    |   |
|--------------------|---|
| 500 mm Tracks      | 12.4 lbs/in <sup>2</sup> (0.87 kg/cm <sup>2</sup> ) |
| Opt. 600 mm Tracks | 10.3 lbs/in <sup>2</sup> (0.72 kg/cm <sup>2</sup> ) |

### Ground Pressure—End Load Spout

|                    |   |
|--------------------|---|
| 500 mm Tracks      | 11.2 lbs/in <sup>2</sup> (0.78 kg/cm <sup>2</sup> ) |
| Opt. 600 mm Tracks | 9.3 lbs/in <sup>2</sup> (0.65 kg/cm <sup>2</sup> )  |

### Powertrain

|                              |                      |
|------------------------------|----------------------|
| Engine                       | Caterpillar C18      |
| Horsepower                   | 765 hp (570 kW)      |
| Clutch                       | PT Tech HPT0 14 FX   |
| Fuel Tank Capacity           | 280 gallons (1060 L) |
| Main Hydraulic Tank Capacity | 110 gallons (416 L)  |

### Controls

Peterson Adaptive Control System  
Radio Remote

### Feed System

Drag Chain 3 Sections, WHD 120, 36¾" w (93 cm)  
Feed Opening 24" h x 40½" w (61 x 103 cm)  
Internal Drive Compression Roll 28" dia (71 cm)  
Feed Rate up to 120 ft/min (3657 cm/min)

### Chipper

Drum Chipper—6 or 12 pocket  
36" dia x 44¾" w (91 x 114 cm)  
Babbitt Knives

### Optional Equipment

Grate System with Chip Accelerator  
Auxiliary Air Compressor, Multiple Knife Options, ⅛" to 1¼" (3 to 32 mm) Chip Lengths, Top Load Spout, Track Pads: 600 mm wide single grouser or double grouser

### Production

60 to 120 tons per hour (60 000 to 120 000 kg) depending on wood species, chip size, and moisture content.

Specifications subject to change  
without notice.

**PETERSON** an Astec Industries Company

PO Box 40490 • Eugene, OR 97404 • Tel 800.269.6520 Fax 541.689.0804 • www.petersoncorp.com

